

Always there to help you

Register your product and get support at
www.philips.com/support



BT3500



User manual

PHILIPS

Contents

1	Important	2
	Important safety instructions	2

2	Your Bluetooth speaker	3
	Introduction	3
	What's in the box	3
	Overview of the speaker	4

3	Get started	5
	Place the speaker	5
	Charge the built-in battery	5
	Turn on/off	5

4	Use Bluetooth devices	6
	Connect a device	6
	Play from Bluetooth device	7
	Control your phone call	7

5	Other features	8
	Listen to an external device	8
	Adjust volume	8
	Specifications	9

7	Troubleshooting	9
	General	9
	About Bluetooth device	9

8	Notice	10
	Disposal of your old product and batteries	11

1 Important



Warning

- Never remove the casing of this speaker.
- Never lubricate any part of this speaker.
- Never place this speaker on other electrical equipment.
- Keep this speaker away from direct sunlight, naked flames or heat.

- ⑫ Apparatus shall not be exposed to dripping or splashing.
- ⑬ Do not place any sources of danger on the apparatus (e.g. liquid filled objects, lighted candles).



Note

- The type plate is located on the back of the product.

Important safety instructions

- ① Read these instructions.
- ② Keep these instructions.
- ③ Heed all warnings.
- ④ Follow all instructions.
- ⑤ Do not use this apparatus near water.
- ⑥ Clean only with dry cloth.
- ⑦ Do not block any ventilation openings. Install in accordance with the manufacturer's instructions.
- ⑧ Do not install near any heat sources such as radiators, heat registers, stoves, or other apparatus (including amplifiers) that produce heat.
- ⑨ Only use attachments/accessories specified by the manufacturer.
- ⑩ Refer all servicing to qualified service personnel. Servicing is required when the apparatus has been damaged in any way, such as liquid has been spilled or objects have fallen into the apparatus, the apparatus has been exposed to rain or moisture, does not operate normally, or has been dropped.
- ⑪ Battery shall not be exposed to excessive heat such as sunshine, fire or the like.

2 Your Bluetooth speaker

Congratulations on your purchase, and welcome to Philips! To fully benefit from the support that Philips offers, register your product at www.philips.com/welcome.

Introduction

With this speaker, you can

- enjoy audio from your Bluetooth-enabled devices or other external audio devices; and
- control the incoming phone call through Bluetooth connection.

What's in the box

Check and identify the contents of your package:

- Main unit
- USB cable
- Short user manual

Overview of the speaker

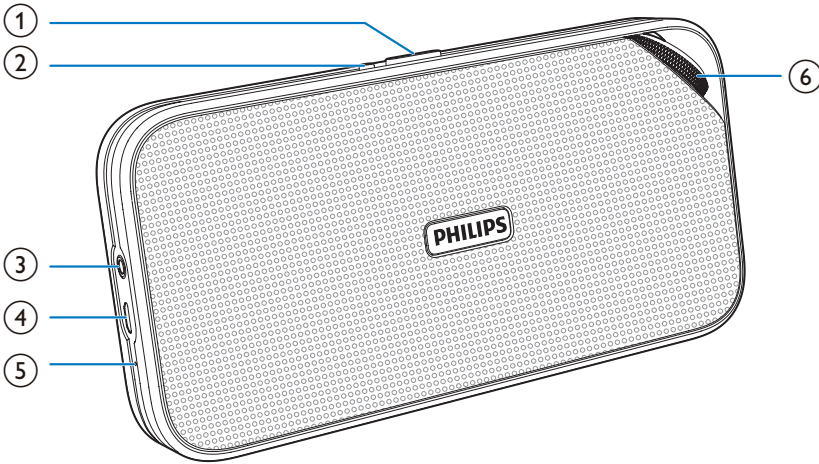

- ① **Source selector (OFF/0/AUDIO IN)**
 - Turn the speaker on or off.
 - Select Bluetooth or AUDIO IN source.
- ② **☎**
 - Answer or reject an incoming call.
 - End the current phone call.
 - Transfer the call to your mobile device.
 - Disconnect Bluetooth connection.
 - Enter Bluetooth pairing mode.
- ③ **AUDIO IN**
 - Connect an external audio device.
- ④ **DC IN**
 - Recharge the built-in battery.
- ⑤ **MIC**
 - Integrated microphone.
- ⑥ **Volume knob**
 - Adjust volume.

3 Get started

Always follow the instructions in this chapter in sequence.

Place the speaker

To place the speaker on a flat surface, pull out the retractable stand from the backside of the speaker:

Charge the built-in battery

The speaker is powered by a built-in rechargeable battery.

Note

- Before use, fully charge the built-in battery.
- The micro USB socket is for charging only.
- Rechargeable battery has a limited number of charge cycles. Battery life and number of charge cycles vary by use and settings.

Connect the USB cable between

- the **DC IN** socket on the speaker; and
- a USB socket of a computer:

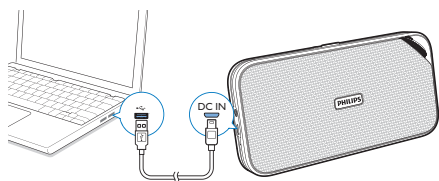

The LED indicator on the top indicates the battery status.

	LED indicator	Battery status
When the speaker is turned off	Solid red	Under charging
When the speaker is turned off	Off	Fully charged
When the speaker is in Bluetooth or Audio-in mode	Flashing red	Low power

Turn on/off

- To turn the speaker on, slide the source selector to **OFF** or **AUDIO IN**.
↳ The speaker switches to the Bluetooth or Audio in mode.
- To turn the speaker off, slide the source selector to **OFF**.

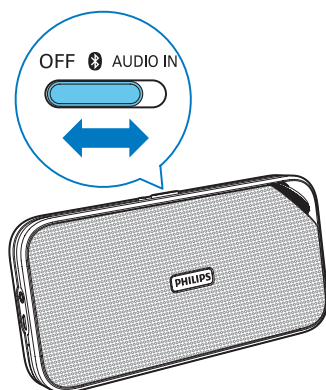

Switch to standby mode

- In Bluetooth mode, if Bluetooth connection is invalid or music playback is stopped for 15 minutes, this speaker switches to standby mode automatically.
 - In Audio-in mode, if the audio-in cable is disconnected or music playback is stopped for 15 minutes, this speaker switches to standby mode automatically.
- ↳ To return to Bluetooth or Audio-in mode, slide the source selector to **OFF** first, then to **📶** or **AUDIO IN** position.

4 Use Bluetooth devices

With this speaker, you can listen to audio from Bluetooth-enabled devices and control the incoming call through Bluetooth.

Connect a device

Note

- Make sure that your Bluetooth device is compatible with this speaker.
- Before pairing a device with this speaker, read its user manual for Bluetooth compatibility.
- The speaker can memorize a maximum of 4 paired devices.
- Make sure that Bluetooth function is enabled on your device, and your device is set as visible to all other Bluetooth devices.
- Any obstacle between this speaker and a Bluetooth device can reduce the operational range.
- Keep away from any other electronic device that may cause interference.

Connect a device manually

Note

- The operational range between this speaker and a Bluetooth device is approximately 10 meters (30 feet).

- 1** Slide the source selector to **📶**.
↳ The LED indicator flashes in blue.
- 2** On your Bluetooth device, enable Bluetooth and search for Bluetooth devices (refer to the user manual of the device).
- 3** When **[BT3500]** is displayed on your device, select it to start pairing and connection. If necessary, enter default password "0000".

↳ After successful pairing and connection, the speaker beeps twice, and the LED indicator turns solid blue.

To disconnect the Bluetooth-enabled device:

- Press and hold **⏻** for 3 seconds;
- Disable Bluetooth on your device; or
- Move the device beyond the communication range.

To reconnect the Bluetooth-enabled device:

- Next time you turn on the speaker, the speaker will reconnect the last connected device automatically; or
- On your Bluetooth device, select "Philips BT3500" on your Bluetooth menu to start connection.

To connect another Bluetooth-enabled device:

- 1** Press and hold **⏻** for 3 seconds to disconnect the currently connected device.
↳ The speaker enters pairing mode.
- 2** Connect another Bluetooth device.

Connect a device through NFC

Near Field Communication (NFC) is a technology that enables short-range wireless communication between various NFC compatible devices, such as mobile phones and IC tags.

If your Bluetooth device supports NFC, you can connect it with this speaker easily.

- 1** Slide the source selector to **Ⓜ**.
- 2** Enable the NFC feature on your Bluetooth enabled device (see the user manual of the device for details).
- 3** Touch the NFC tag on the top of the speaker with the back of your Bluetooth device.

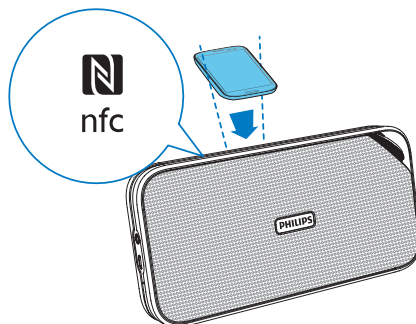

- 4** On your Bluetooth device, accept the pairing request with "BT3500". If necessary, input "0000" as the pairing password.
- 5** Follow the on-screen instructions to complete the pairing and connection.
↳ After successful pairing and connection, the speaker beeps twice and the LED indicator turns solid blue.

LED indicator	Description
Flashing blue	Connecting or waiting for connection
Solid blue	Connected

Play from Bluetooth device

Note





- If there is an incoming call on the connected mobile phone, music play pauses.

After successful Bluetooth connection, play audio on the Bluetooth device.

- ↳ Audio streams from your Bluetooth device to the speaker.

Control your phone call

After Bluetooth connection, you can control an incoming call with this speaker:

Button	Function
	Press to answer an incoming call.
	Press and hold to reject an incoming call.
	During a call, press to end the current call.
	During a call, press and hold to transfer the call to your mobile device.

Note

- You can talk through the microphone of the speaker.
- Music play pauses when there is an incoming call, and resumes when your phone call ends.

5 Other features

Listen to an external device

With this speaker, you can also listen to an external audio device such as an MP3 player:

- 1 Connect an audio input cable with a 3.5 mm connector on both ends to
 - the **AUDIO IN** socket on this speaker;
 - and
 - the headphone socket on the external device.

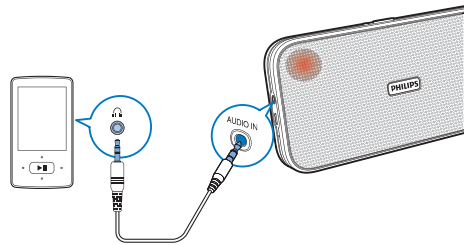

- 2 Slide the source selector to **AUDIO IN**.
↳ The LED indicator lights up in red.
- 3 Play audio on the external device (refer to its user manual).

Adjust volume

Rotate the volume knob to increase or decrease the volume.

6 Product information

Note

- Product information is subject to change without prior notice.

Specifications

Amplifier

Rated Output Power	2 X 5 W RMS
Signal to Noise Ratio	> 62 dBA
AUX Input	600 mV

Bluetooth

Bluetooth version	V3.0
Supported profiles	HFP v1.6, A2DP v2.1, AVRCP v1.0
Range	10 m (Free space)

General information

Power Supply (through USB socket)	5 V --- 1 A
Built-in Battery	Li-polymer battery (3.7V, 2200 mAh)
Dimensions - Main Unit (W x H x D)	201 x 101 x 35 mm
Weight - Main Unit	0,5 kg

7 Troubleshooting

Warning

- Never remove the casing of this device.

To keep the warranty valid, never try to repair the system yourself.

If you encounter problems when using this device, check the following points before requesting service. If the problem remains unsolved, go to the Philips Web page (www.philips.com/support). When you contact Philips, make sure that the device is nearby and the model number and serial number are available.

General

No power

- Recharge your speaker.

No sound

- Adjust volume on the speaker or the Bluetooth-connected device.
- Make sure that your Bluetooth device is within the effective operational range.

No response from the speaker

- Restart the speaker.

About Bluetooth device

The audio quality is poor after connection with a Bluetooth-enabled device.

- The Bluetooth reception is poor: Move the device closer to this product or remove any obstacle between them.

Cannot connect with the device.

- The Bluetooth function of the device is not enabled. Refer to the user manual of the device for how to enable the function.

- This product is already connected with another Bluetooth-enabled device. Disconnect that device and then try again.

The paired device connects and disconnects constantly.

- The Bluetooth reception is poor. Move the device closer to this product or remove any obstacle between them.
- For some devices, Bluetooth connection may be deactivated automatically as a power-saving feature. This does not indicate any malfunction of this product.

8 Notice

Any changes or modifications made to this device that are not expressly approved by WOOX Innovations may void the user's authority to operate the equipment.

Notice for the USA and Canada

The device complies with Part 15 of the FCC Rules, and Industry Canada licence-exempt RSS standard(s). Operation is subject to the following two conditions:

- 1** this device may not cause harmful interference, and
- 2** this device must accept any interference received, including interference that may cause undesired operation.

This equipment has been tested and found to comply with the limits for a Class B digital device, pursuant to part 15 of the FCC Rules.

These limits are designed to provide reasonable protection against harmful interference in a residential installation. This equipment generates, uses, and can radiate radio frequency energy and, if not installed and used in accordance with the instruction manual, may cause harmful interference to radio communications.

However, there is no guarantee that interference will not occur in a particular installation. If this equipment does cause harmful interference to radio or television reception, which can be determined by turning the equipment off and on, the user is encouraged to try to correct the interference by one or more of the following measures:

- Relocate the receiving antenna.
- Increase the separation between equipment and receiver.
- Connect the equipment into an outlet on a circuit different from that to which the receiver is connected.
- Consult the dealer or an experienced radio/TV technician for help.

RF Radiation Exposure Statement: This equipment complies with FCC's and IC's RF radiation exposure limits set forth for an uncontrolled environment. The antenna(s) used for this transmitter must be installed and operated to provide a separation distance of at least 20 cm from all persons and must not be collocated or operating in conjunction with any other antenna or transmitter. Installers must ensure that 20cm separation distance will be maintained between the device (excluding its handset) and users.

CAN ICES-3(B)/NMB-3(B).

Disposal of your old product and batteries

Your product is designed and manufactured with high quality materials and components, which can be recycled and reused. Never dispose of your product with other household waste. Please inform yourself about the local rules on the separate collection of electrical and electronic products and batteries. The correct disposal of these products helps prevent potentially negative consequences on the environment and human health. Your product contains batteries, which cannot be disposed of with normal household waste. Please inform yourself about the local rules on separate collection of batteries. The correct disposal of batteries helps prevent potentially negative consequences on the environment and human health. Please visit www.recycle.philips.com for additional information on a recycling center in your area.

Caution

- Removal of the built-in battery invalidates the warranty and may destroy the product.

Always bring your product to a professional to remove the built-in battery.

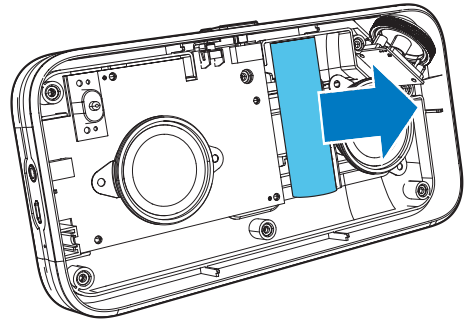

Environmental information

All unnecessary packaging has been omitted. We have tried to make the packaging easy to separate into three materials: cardboard (box), polystyrene foam (buffer) and polyethylene (bags, protective foam sheet.) Your system consists of materials which can be recycled and reused if disassembled by a specialized company. Please observe the local regulations regarding the disposal of packaging materials, exhausted batteries and old equipment.

Bluetooth

The Bluetooth® word mark and logos are registered trademarks owned by Bluetooth SIG, Inc. and any use of such marks by WOOX Innovations is under license.



The N Mark is a trademark or registered trademark of NFC Forum, Inc. in the United States and in other countries.



Specifications are subject to change without notice.
2014 © WOOX Innovations Limited. All rights reserved.
Philips and the Philips' Shield Emblem are registered
trademarks of Koninklijke Philips N.V. and are used by WOOX
Innovations Limited under license from Koninklijke Philips N.V.

BT3500_37_UM_V2.0

